

Panel	Description
1	42" 90° Connector
2	6" x 42" Panel
3	42" 90° Connector
4	18" x 42" Panel w/ 38" Connector
5	42" 90° Connector
6	6" x 42" Panel
7	42" 90° Connector
8	18" x 42" Panel w/ 38" Connector
9	6.25" x 38" Panel
10	38" 90° Connector
11	22" x 38" Panel w/Door
12	38" 90° Connector
13	18" x 38" Panel
14	38" 90° Connector
15	22" x 38" Panel
16	38" 90° Connector
17	38" 180° Connector

- Steps:
- 1) Assemble the panels in numerical order as shown below.
 - 2) Attach the EcoGlass sign with stand-off barrels and screw caps.
 - 4) Place counter tops on assembled pedestals.

Panels Labeled with Blue Numbers

See *Eco Panel Installation* general information page.

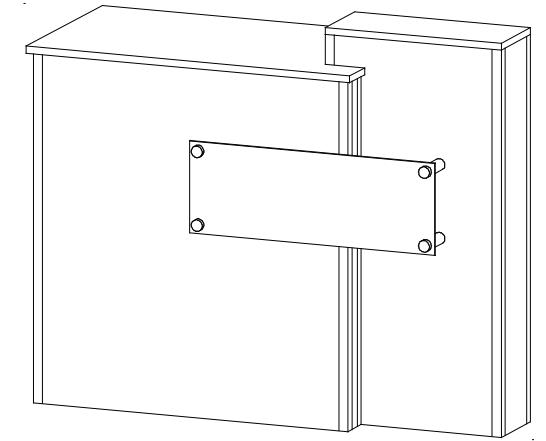
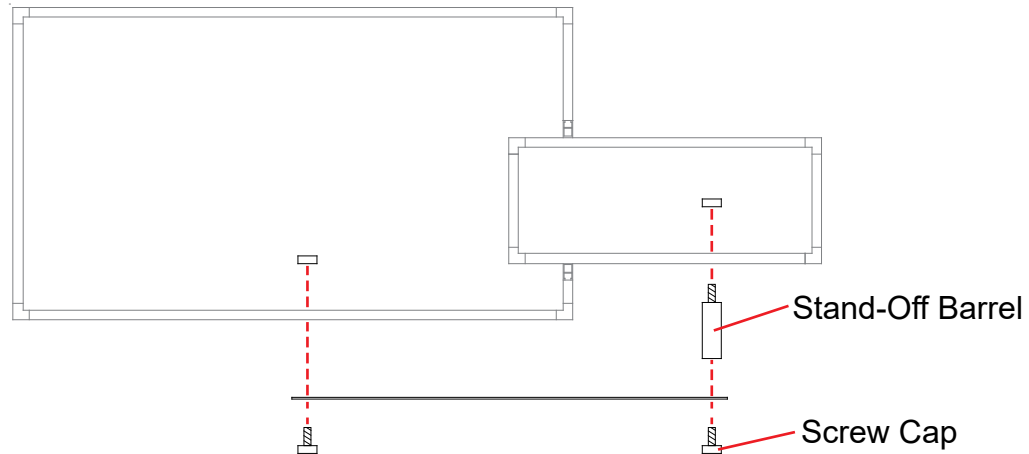

When assembled

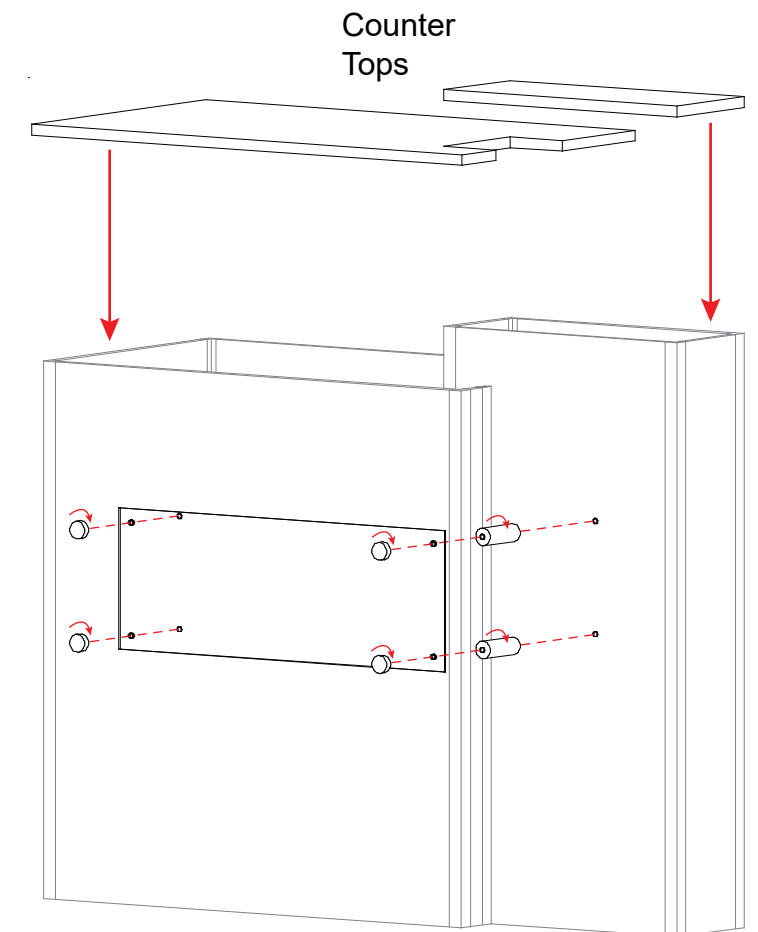
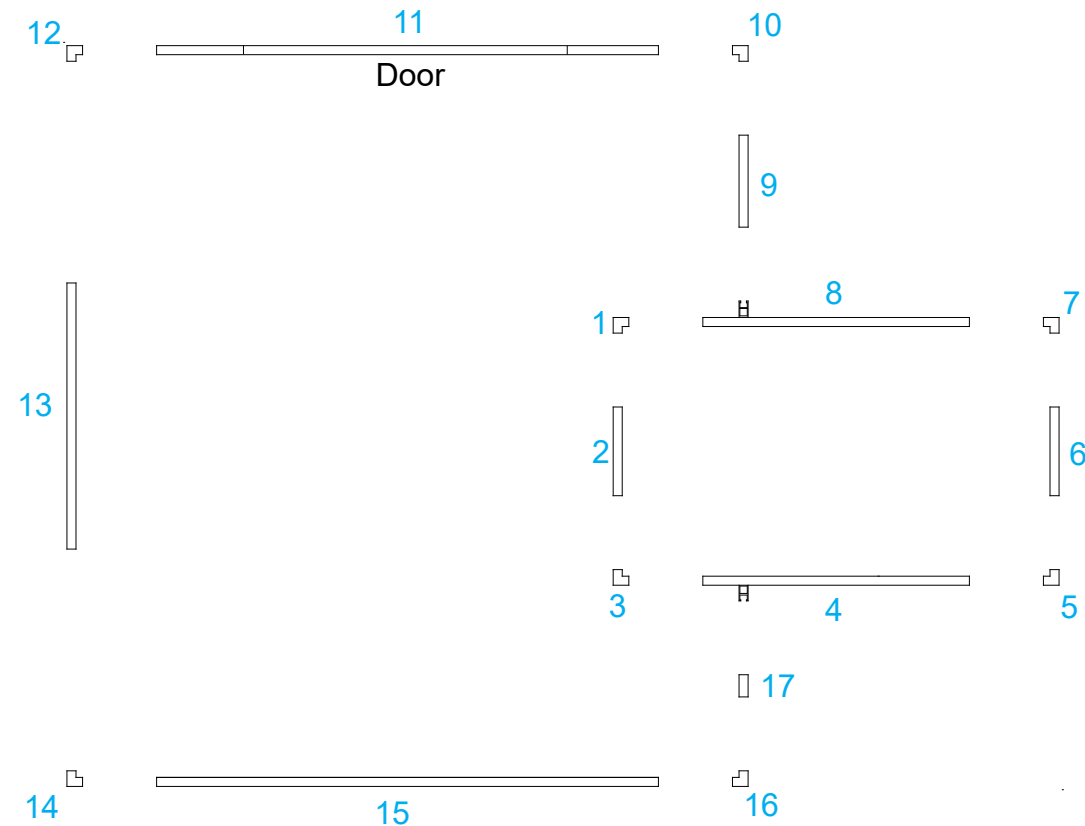

ECO Panel Install

- 1 Place ECO panel together with a vertical offset, slide down to lock connector in place.
- 2 Panel Corner Connectors are installed just like ECO panels. Remove by off-setting top lock clips horizontally followed by separating vertically.

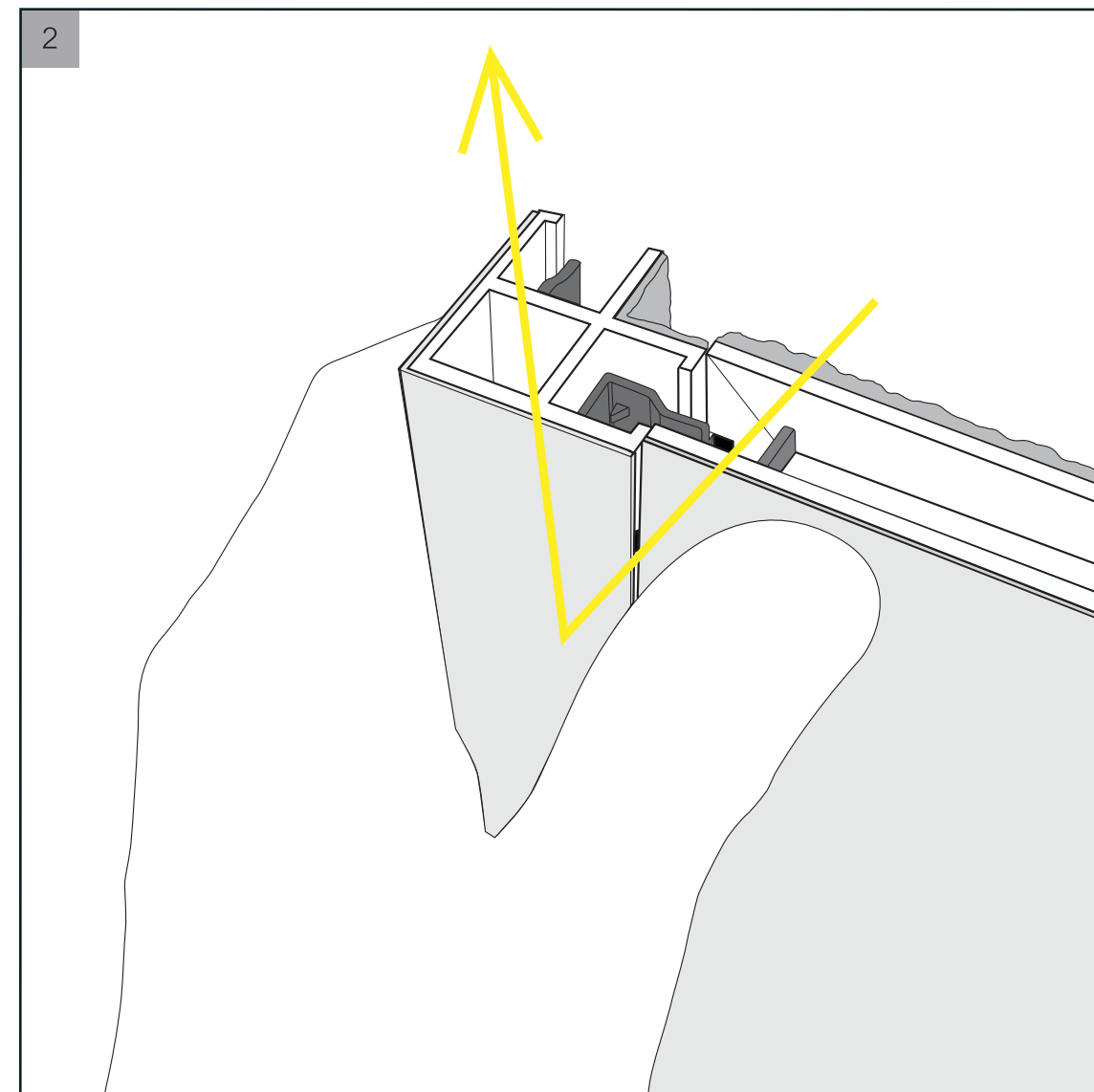
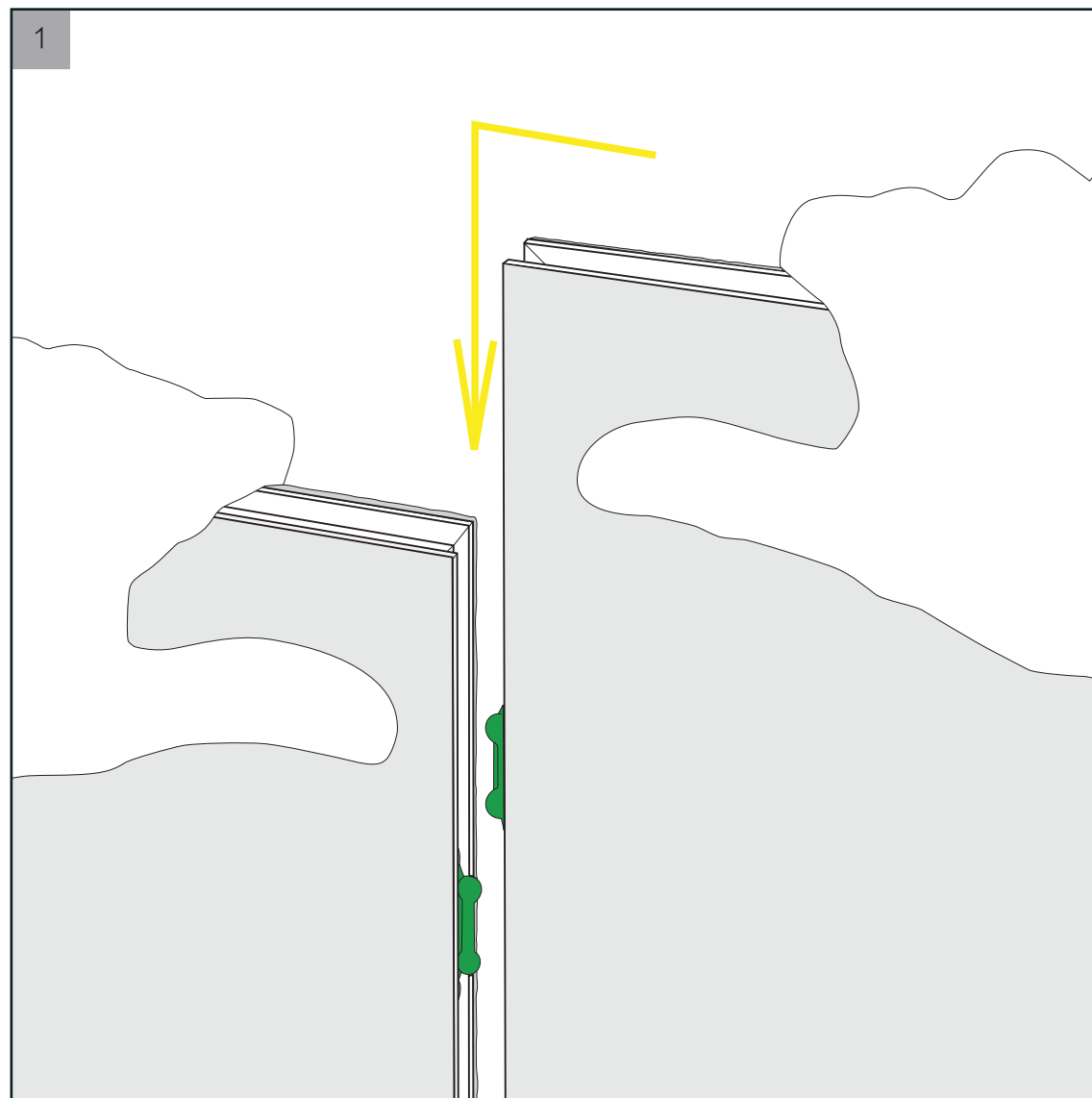

Top View of Each Level

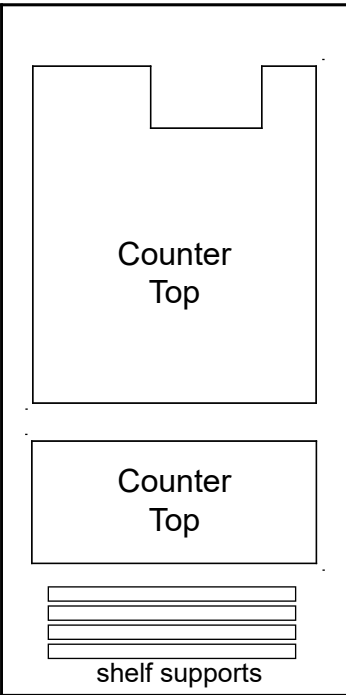

Level 1

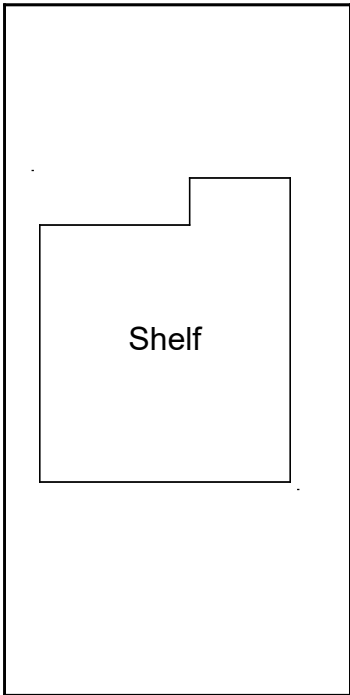

Level 2

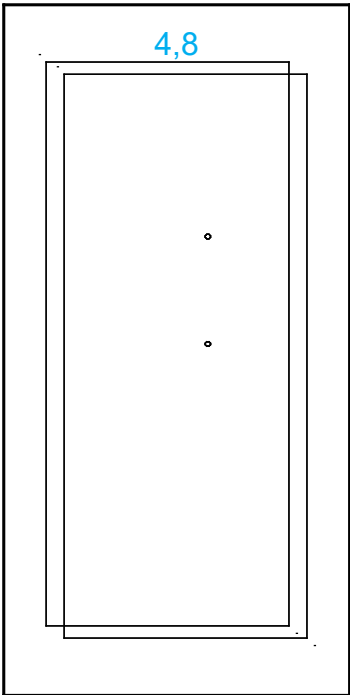

Level 3

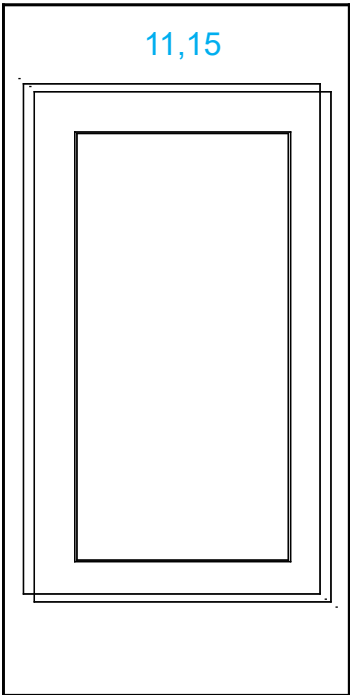

Level 4



Top View of Each Level

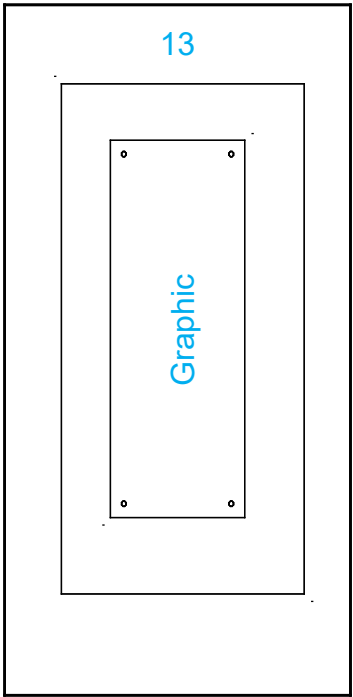

Level 1
(Bottom level)

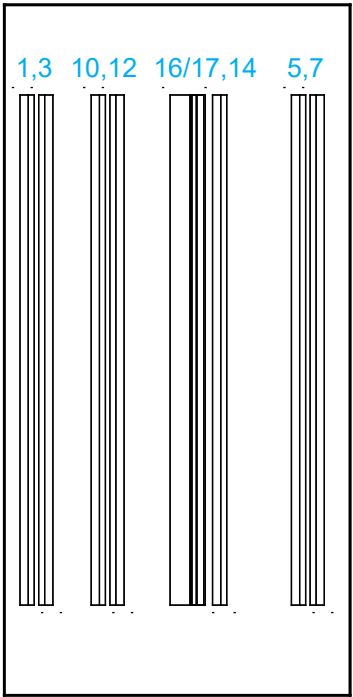

Level 2

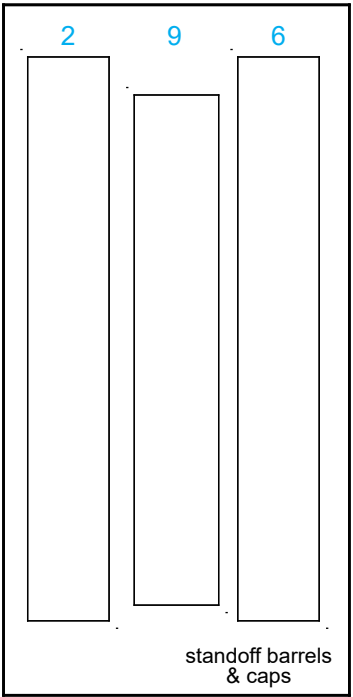

Level 3